



San Jose Makeover

2009 Remodelers Awards
Category 1-C

SNC Sport Nobles Construction, Inc.
Custom Builder

The Plan

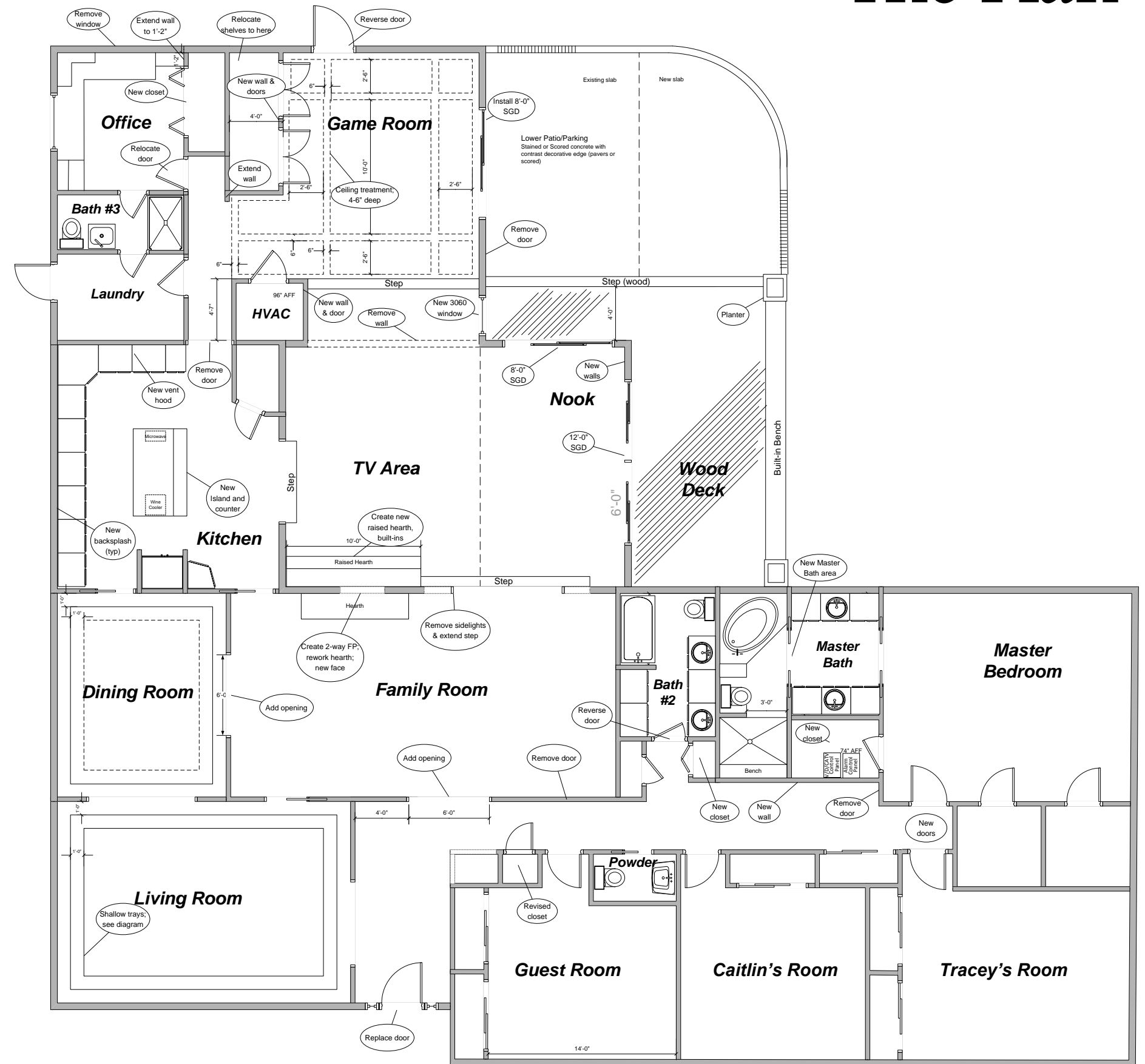

2009 Remodelers Awards

SNC Sport Nobles Construction, Inc.
Custom Builder

The Kitchen



This previously updated kitchen needed a facelift to increase both curb appeal and functionality.

By adding additional lighting, refreshing the walls with a coat of stone finish paint and installing an artsy mosaic backsplash with an accent band, this kitchen went from dark and gloomy to bright and cheerful. The functionality was improved by separating the island work space from the breakfast area. A brand new island was created with a separate breakfast bar and room for one additional seat hovering the Arctic white tile in front of the island. Saving space in the main working area, the island boasts a wine cooler on one end and a pull-out microwave drawer on the other. The glass front cabinets from the original island were repurposed to create a separate buffet area great for display. The new crown molding, trim and skirt for the window, under-cabinet lighting, custom built hood with insert and unique pantry door add character to this lively kitchen.



2009 Remodelers Awards

SNC Sport Nobles Construction, Inc.
Custom Builder

The Family Room



The family room benefited from the expanded opening from the foyer by bringing in more natural light. The existing fireplace, which was gray brick, was resurfaced in flagstone with travertine tile vertical ends, increasing the illusion of height. This was accented by a new mantle, sconces on either side and a directed recessed light in front.

The storage display wall was rebuilt to give a less cluttered, more symmetrical, artistic appearance with the addition of the LED lighting behind each niche to feature art and add lighting to the room. New carpet and furnishings were added.



2009 Remodelers Awards

SNC Sport Nobles Construction, Inc.
Custom Builder

The Family Room



The living and dining rooms, which had large expanses of eight foot ceilings, were given mini-tray ceilings by creating two one inch drops around the perimeter of the rooms. The finished effect, while reducing the height by two inches around the outside, actually made the ceilings appear higher and the rooms better proportioned.

A six foot opening was created between the dining and family rooms, expanding the feeling of spaciousness in the dining room and adding natural light to the family room.



2009 Remodelers Awards

SNC Sport Nobles Construction, Inc.
Custom Builder

The Master Bath

This master bath was transformed from dim and grim to glam!



This before cramped bathroom was restructured to incorporate his and her vanities mirroring each other, a separate shower and a deep soaking tub. The solid wood vanities house repurposed lighting, faucets and sinks, a Silestone top and two spacious towers great for appeal and storage. The tower doors offer a unique design made of frosted glass and accent metal. Finishing touches include new crown molding and trim and added pocket doors for privacy.



2009 Remodelers Awards

SNC Sport Nobles Construction, Inc.
Custom Builder

The Master Bath

Tranquil.

Peaceful.

Relaxing.

Getaway.

Calming.

Quiet.



What was once a confined corner has been made into a serene setting complete with a luxurious, deep soaking tub. The tub is saturated in octagon shaped stone tiles with a mosaic accent band as a border, which wraps around to the side of the cozy storage and candle setting area. The tub valves, which include a pull-out wand, are conveniently located at the lay down side of the tub to allow for easy adjustment of water temperature without having to get up. A great haven after a long day!

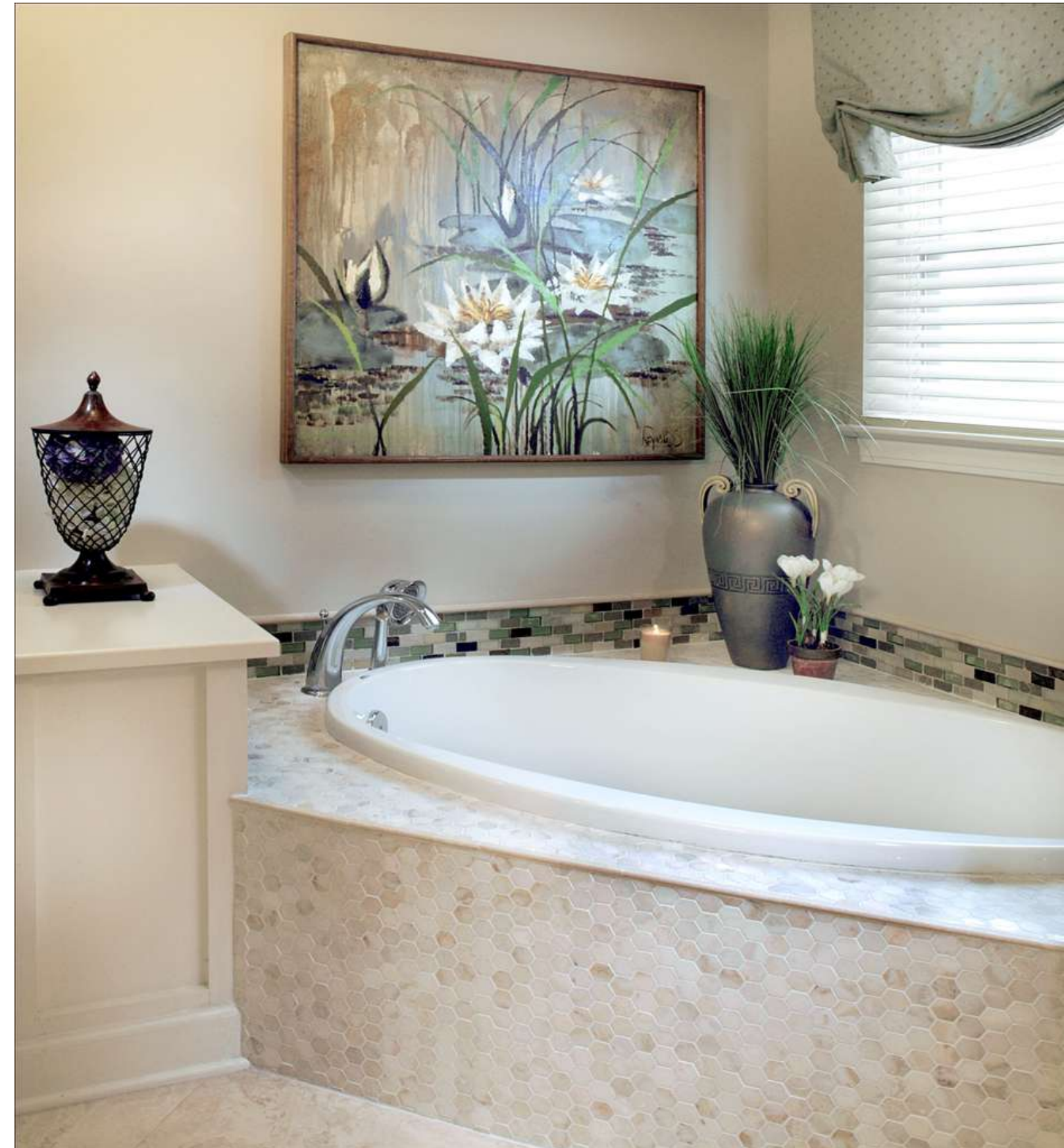

2009 Remodelers Awards

SNC Sport Nobles Construction, Inc.
Custom Builder

The Master Bath

While making the most of this space, this well-designed shower is both elegant and practical. The shower is complete with seamless glass doors, octagon shaped stone floors, stone walls with built-in niches and a sitting bench. Although there are four different varieties of tile in the shower, the mosaic design is the elaborate focal point. Also featured is a multi-functional shower valve with a rain head and shower head. In this space showering will feel more like a luxury than a necessity.



This space was improved by separating the shower and bathing area.



2009 Remodelers Awards

SNC Sport Nobles Construction, Inc.
Custom Builder

The TV Room



This area was previously a partially enclosed porch with a metal roof, limited egress to the lovely rear yard, the original brick walls and no place to house the television. The roof was expanded and a finished room was created adding large expanses of Marvin sliding glass doors to a new deck. The fireplace in the family room was reworked to become a two-way fireplace, now open to the family and TV rooms. A TV niche over the fireplace was added for a flat screen TV, new storage cabinets for equipment and new surfacing in split-face mosaic stone. The flooring was replaced and the lighting upgraded.



2009 Remodelers Awards

SNC Sport Nobles Construction, Inc.
Custom Builder

The Family Room



2009 Remodelers Awards

SNC Sport Nobles Construction, Inc.
Custom Builder

The Rear Exterior



2009 Remodelers Awards

SNC Sport Nobles Construction, Inc.
Custom Builder

The TV Area



2009 Remodelers Awards

